



# REHACARE 2009

14-17 OCTOBER  
DÜSSELDORF, GERMANY



## EXHIBITING ON THE UK PAVILION

PROJECT DELIVERED ON BEHALF OF  
UK TRADE & INVESTMENT BY:

**MEDILINK YORKSHIRE & HUMBER**





**REHACARE IS THE NO 1 TRADE FAIR FOR  
REHABILITATION, PREVENTION, INTEGRATION, CARE  
AND ASSISTIVE TECHNOLOGIES  
PRODUCTS IN THE WORLD.**

**EVENT INFORMATION:**

**DATES:** OCTOBER 14<sup>TH</sup> - 17<sup>TH</sup>, 2009

**VENUE:** DUSSELDORF, GERMANY

**EXHIBITORS:** 800

**EXPECTED VISITORS:** 56,000

**ABOUT REHACARE:**

The exhibition covers a wide range of rehabilitation equipment and supplies as well as aids for daily living.

RehaCare is a **decision-makers event**. 70% of the visitors are from the trade, nearly half of whom report having direct purchasing authority.



In 2008 758 exhibitors from 29 countries exhibited at RehaCare and over 52,000 visiting professionals attended the four day show, an increase of 10% of 2007 figures. Further details can be found at [www.rehacare.de](http://www.rehacare.de)





## REHACARE PRODUCT RANGE

- Daily living aids
- Household and nutrition
- Physical care and hygiene
- Mobility
- Communication
- Building and living
- Safety and monitoring systems
- Pedagogy, education, and further training
- Workplace and occupation
- Physical training, physiotherapy and ergotherapy
- Orthopaedic aids
- Nursing and medical care
- Clothing, protective equipment
- Leisure, sports and recreation
- Travel
- Associations, institutions, organisations

## VISITOR TARGET GROUPS:

- Medical and Sanitary Specialised Trade
  - Rehabilitation and Special Facilities
  - Orthopaedic Trade
- Industry for Medical and Therapeutic Aids / Other Industry
  - Hospital / Clinics
- Nursing Home / Home for the Elderly
  - Public Authorities
  - Disabled People Organisation
- Disabled People Sports Organisation
  - Ambulant Nursing / Care Service
  - Cost Unit
- Surgeries / Medical Laboratory / Institutions
- University / College of Higher Education / Technical College



## THE EXHIBITION PACKAGE:

- **UKTI TAP grants of £1000** available to eligible companies. Please note these are limited in number and are awarded strictly on a **first come first served basis**
- Full support & advice from Medilink Y&H and **UKTI healthcare specialists** both at home and overseas.
- Full pre-exhibition **administration support** from Medilink and UK Trade and Investment
- Booking of **exhibition space & project management** of your exhibition stand on the British Pavilion at the event (Exhibition space including shell scheme = **£319per m<sup>2</sup>**)
- Recommended **accommodation arrangements** at reduced rate and full support of Pressplan Travel Ltd.
- Group freight shipment arrangements
- Arrangement of meetings UKT&I commercial officers from available countries.
- Use of Pavilion **Interpreters** for meetings or language assistance throughout the exhibition.
- Use of the Pavilion **Internet facilities**
- Hot and cold refreshments free of charge on the pavilion to the UK exhibitors all week





For a service fee of £595 +VAT (Medilink Non-members: £675 +VAT) your company can exhibit as part of the official **British Pavilion** sponsored and supported by UK Trade & Investment and benefit from all of the above.

### EXHIBITION CENTRE LAYOUT

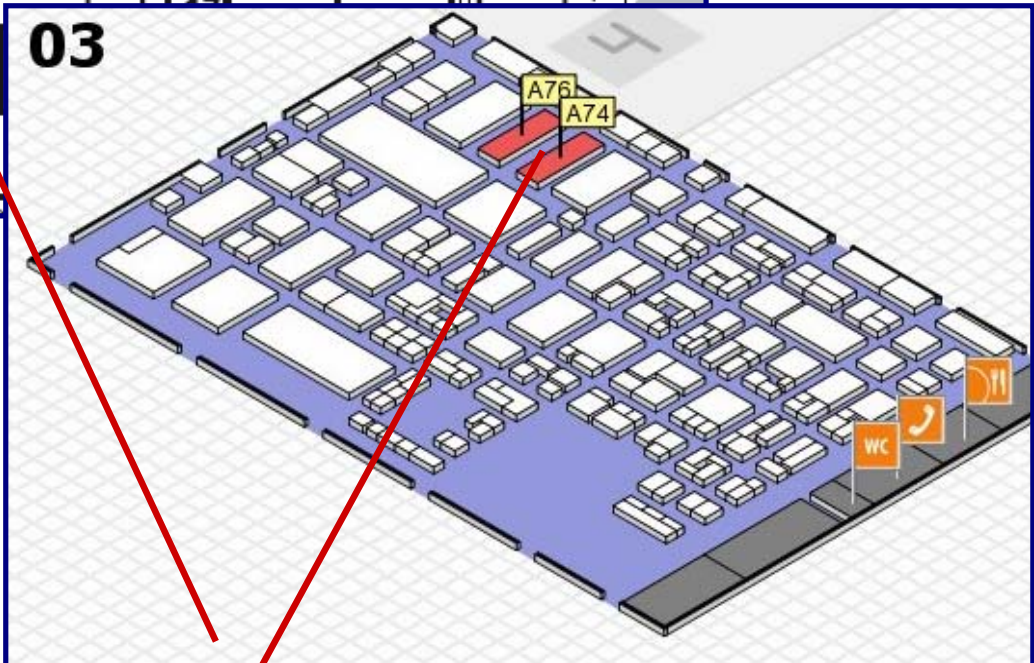
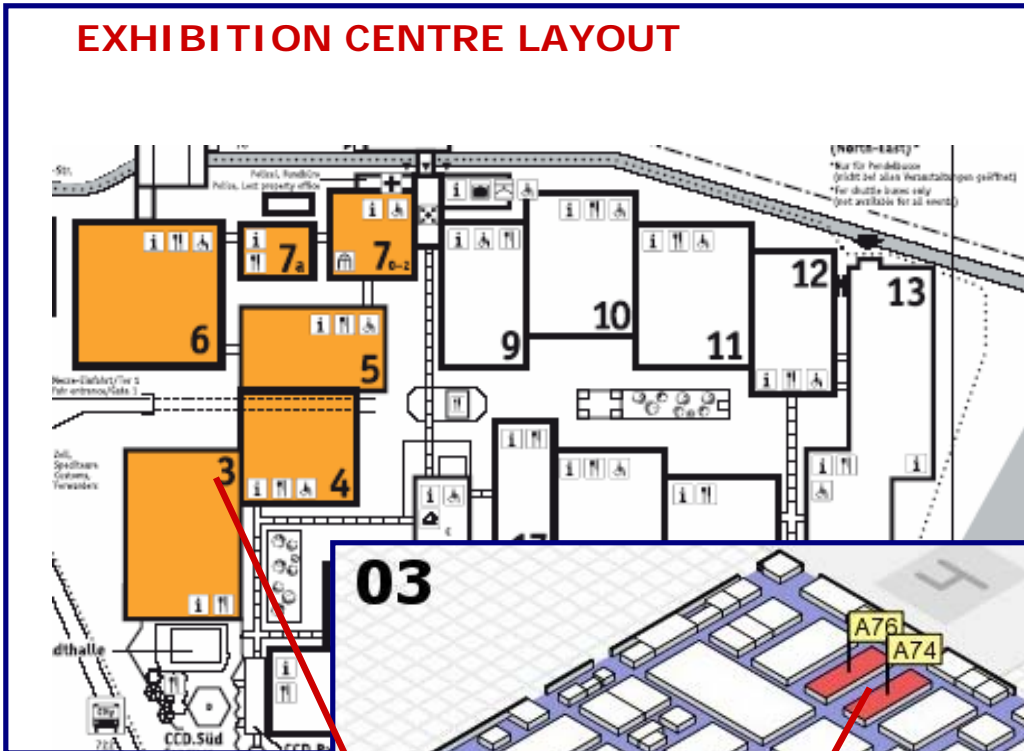

**LOCATION OF BRITISH PAVILION WITHIN HALL 3**



## STAND OPTIONS AND COSTS

Cost per square meter:

£319+VAT

Management Fee:

£595+VAT (Medilink Members)

£675+VAT (non- Members)

Management fee includes contribution towards pavilion Interpreters, Pavilion Internet access, hot and cold refreshments during exhibition and full pre show support from Medilink.

UK Trade & Investment Grants:

£1000 \* subject to eligibility

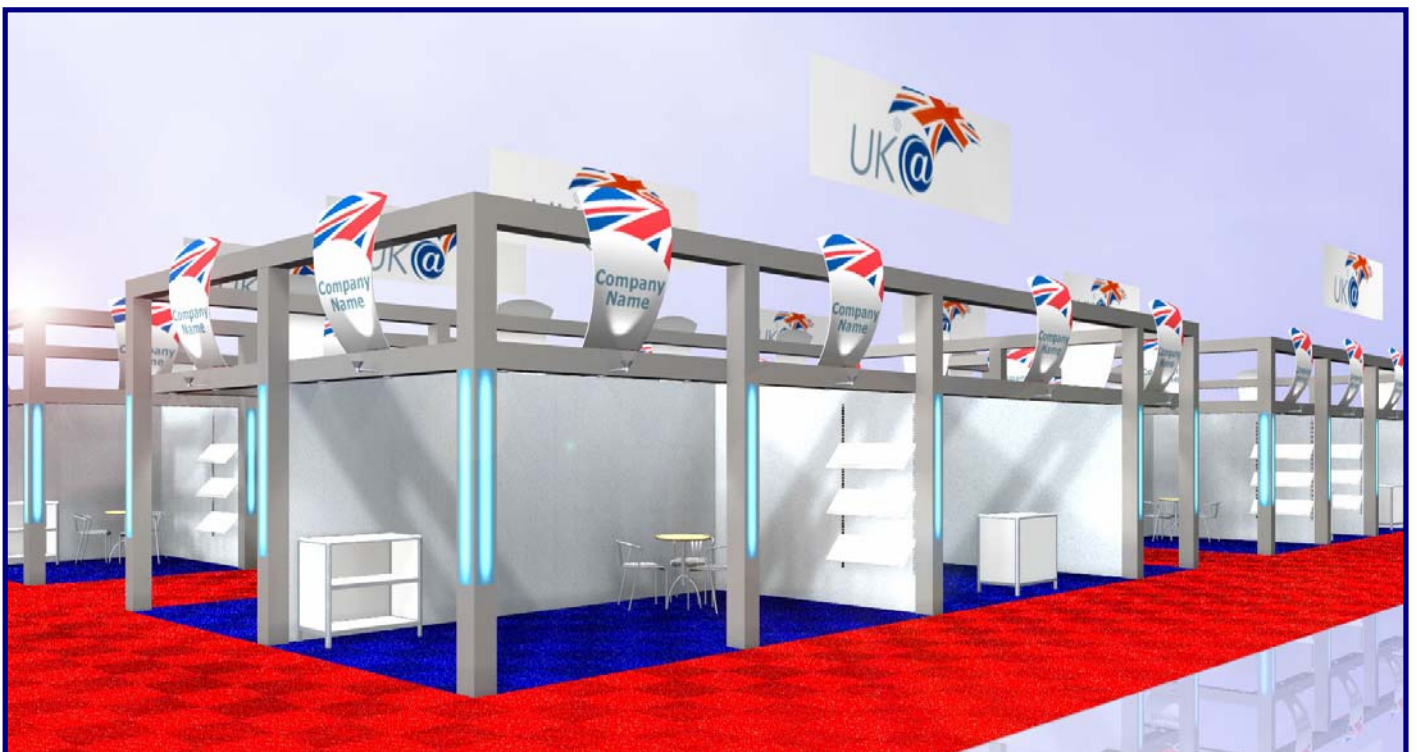

## Small Stands

		Cost of stand space (£319 per sq m)	Management Fee	Total (+ VAT)	Total after Grant (+ VAT)
6 sq m	3m x 2m	£1914	£595	£2509	£1509
9 sq m	3m x 3m	£2871	£595	£3466	£2466
12 sq m	4m x 3m	£3828	£595	£4423	£3423
15 sq m	5m x 3m	£4785	£595	£5380	£4380

## Medium Stands

		Cost of stand space (£319 per sq m)	Management Fee	Total (+ VAT)	Total after Grant (+ VAT)
16 sq m	4m x 4m	£5104	£595	£5699	£4699
18sq m	6m x 3m	£5742	£595	£6337	£5337
20 sq m	5m x 4m	£6380	£595	£6975	£5975
24 sq m	6m x 4m	£7656	£595	£8251	£7251

## Large Stands

		Cost of stand space (£319 per sq m)	Management Fee	Total (+ VAT)	Total after Grant (+ VAT)
28sq m	7m x 4m	£8932	£595	£9527	£8527
36sq m	6 m x 6m	£11484	£595	£12079	£11079
42sq m	7m x 6m	£13398	£595	£13993	£12993
48sq m	8 m x 6m	£15312	£595	£15907	£14907



### HOW TO REGISTER:

If you wish to exhibit as part of the British Pavilion at **Rehacare 2009** please complete the Rehacare 2009 registration form and send it with the relevant deposit as detailed on the registration form to David Howarth, Medilink Y&H International Coordinator, 301 Glossop Road, Sheffield, S10 2HL.

### CONTACT DETAILS:



**David Howarth**

International Coordinator

[d.howarth@medilink.co.uk](mailto:d.howarth@medilink.co.uk)

0114 222 7458



**Charlotte Fraser**

International Manager- Medilink

UKTI Healthcare Sector Specialist for  
Yorkshire and Humber

[c.fraser@medilink.co.uk](mailto:c.fraser@medilink.co.uk)

0114 222 7453

**COMPLETED REGISTRATION FORMS, WITH A DEPOSIT, WILL BE ACCEPTED IN  
ORDER OF RECEIPT**

**DEADLINE 30 JUNE 2009**